

# PRECISION MACHINE VISION LENS

## MV0814TL

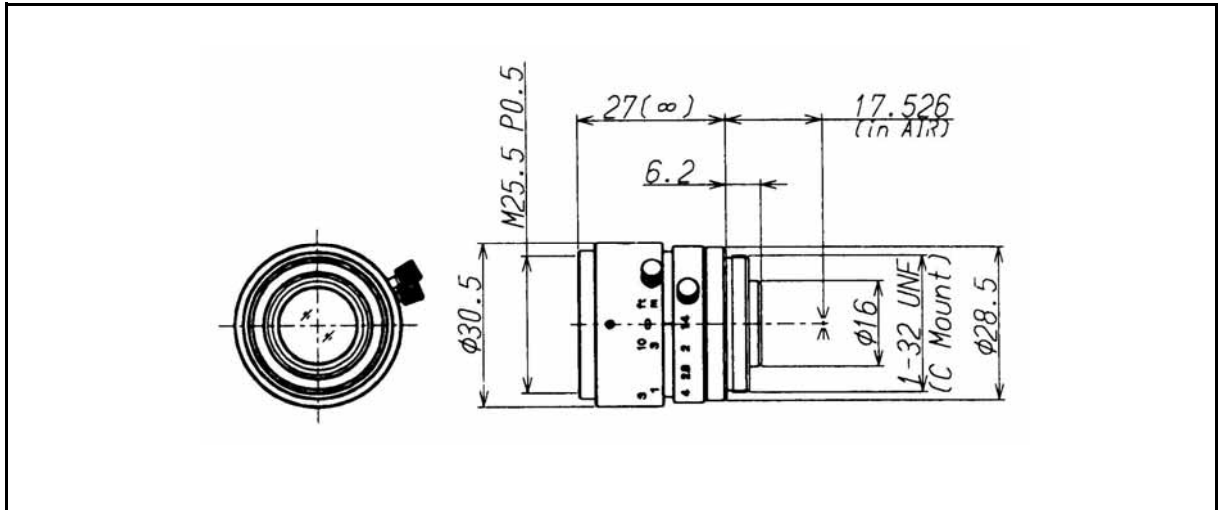

<b>Image Format:</b>	2/3-inch
<b>Focal Length:</b>	8mm
<b>Relative Aperture:</b>	F = 1: 1.4
<b>Iris Range:</b>	1.4 - 16
<b>Angular Field of View:</b>	<b>Horizontal:</b> 59.3°
	<b>Vertical:</b> 45.2°
<b>Minimum Object Distance(MOD):</b>	0.26m
<b>Back Focus:</b>	11.60mm
<b>Flange Back:</b>	17.526mm
<b>Operation:</b>	<b>Focus:</b> Manual with lock
	<b>Iris:</b> Manual with lock
<b>Lens Mount:</b>	<b>C-Mount Type</b>
<b>Filter Screw:</b>	25.5mm, P = 0.5
<b>Dimensions:</b>	φ30.5 x 27mm
<b>Weight:</b>	48g
<b>Operating Temperature:</b>	-10 ~ +45°C

Note : Angular of field of view (H x V) is on the 2/3-inch CCD sensor at MOD.