

PRECISION MACHINE VISION LENS

MV2516TL

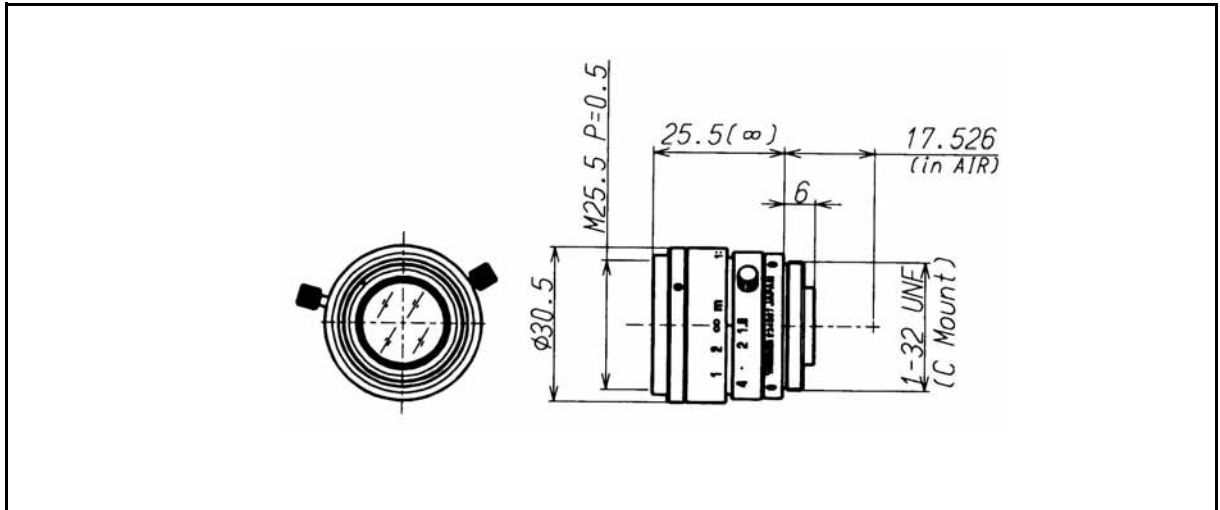

Image Format:	2/3-inch
Focal Length:	25mm
Relative Aperture:	F = 1.6
Iris Range:	1.6 - 16
Angular Field of View:	Horizontal: 20.10°
	Vertical: 15.00°
Minimum Object Distance(MOD):	0.25m
Back Focus:	11.60mm
Flange Back:	17.526mm
Operation:	Focus: Manual with lock
	Iris: Manual with lock
Lens Mount:	C-Mount Type
Filter Screw:	25.5mm, P = 0.5
Dimensions:	φ30.5 x 25.5mm
Weight:	40g
Operating Temperature:	-5 ~ +50°C

Note : Anguar of field of view (HxV) is on the 2/3-inch CCD sensor at MOD.