

PRECISION MACHINE VISION LENS

MV3521TL

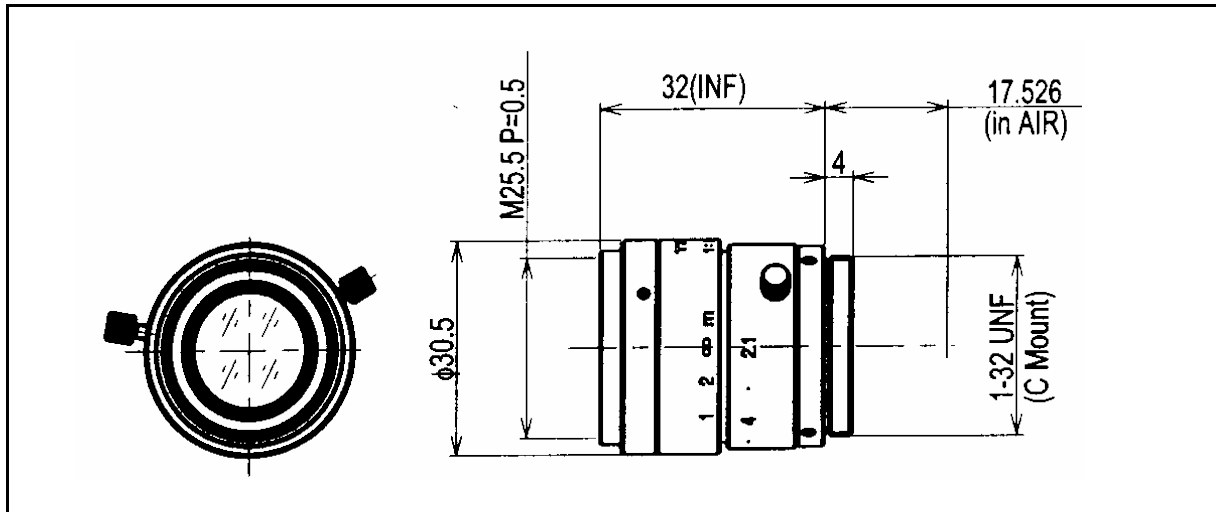

Image Format:	2/3-inch
Focal Length:	35mm
Relative Aperture:	F = 2.1
Iris Range:	2.1 - 22
Angular Field of View:	Horizontal: 14.3° Vertical: 10.8°
Minimum Object Distance(MOD):	0.3m
Back Focus:	15.53mm
Flange Back:	17.526mm
Operation:	Focus: Manual with lock Iris: Manual with lock
Lens Mount:	C-Mount Type
Filter Screw:	25.5mm, P = 0.5
Dimensions:	$\phi 30.5 \times 32.0$ mm
Weight:	44g
Operating Temperature:	-10 ~ +60°C

Note : Anguar of field of view (HxV) is on the 2/3-inch CCD sensor at MOD.